

4 产品外形及安装尺寸

E1

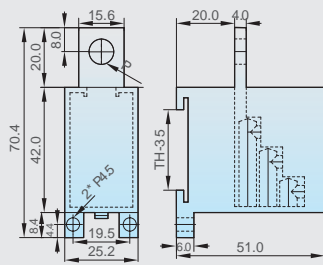
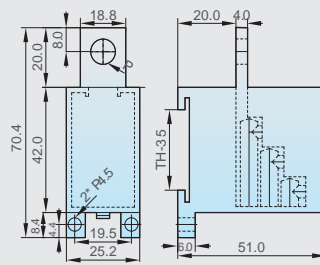
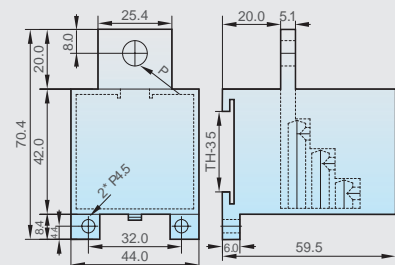
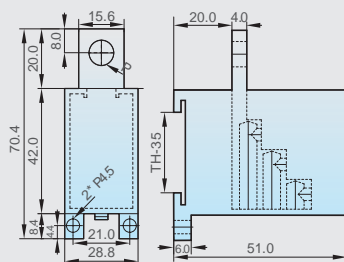

FJ6G-100/10-35

FJ6G/250/16-50/2
FJ6G/250/16-50/4FJ6G/400/25-70/4
FJ6G/400/25-70/12

FJ6G/100/10-35/6

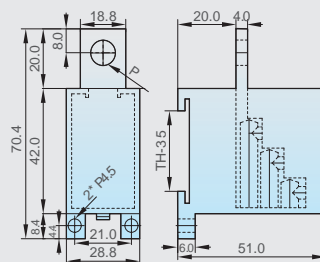
FJ6G/250/16-50/6
FJ6G/250/16-50/9

5 订货须知

如需订购配合 100A 塑壳断路器使用，一路进，两路出，进线 10-35mm²，出线 1.5-25mm² 的开关端子，则订货代号为：开关端子 FJ6G/100/10-35/2×25（开单单位为只）。